

**■ Mounting Dimensional Description**  
**AF39-159**

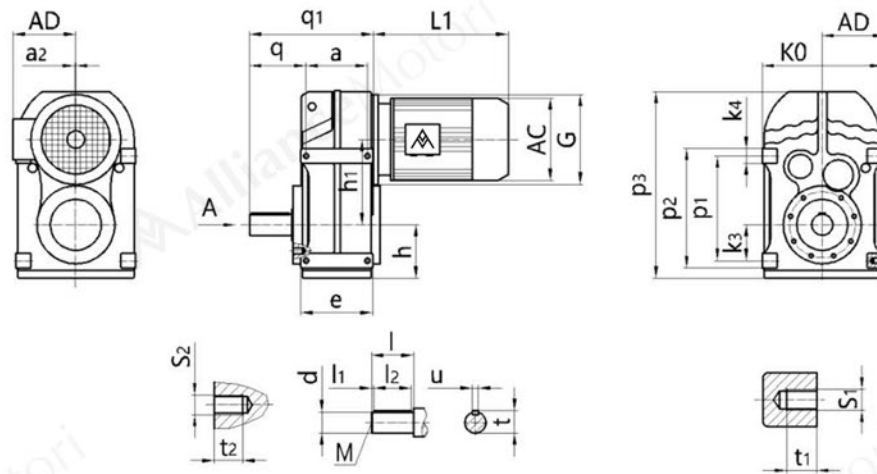

(Fig.A Mounting Dimension)

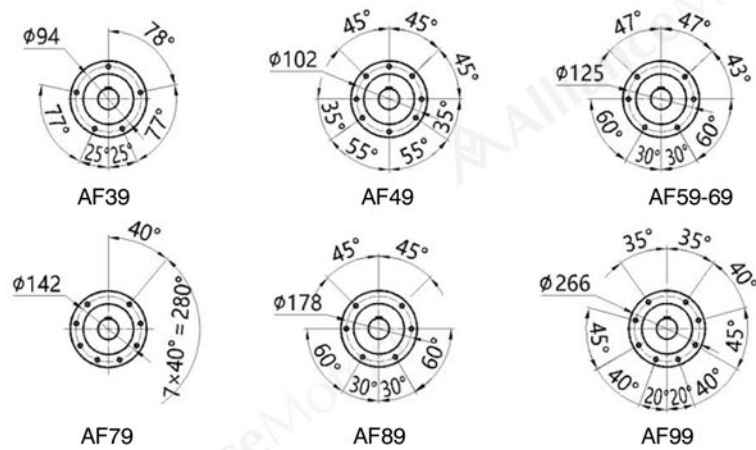

Type Size	$q_1$	$q$	$a$	$h_1$	$h$	$e$	$p_3$	$p_2$	$p_1$	$k_3$	$k_4$	$K_0$	$G$	Motor Size			
	$S_1$	$t_1$	$u$	$t$	$l_1$	$l_2$	$l$	$d$	$M$	$S_2$	$t_2$	$a_2$		AC	AD	L1	
<b>AF39</b>	160 M8	72.5 15	77 8	112 28	77 5	95 40	256 50	135 $\Phi 25k6$	115 M10	31 M8	20 15	165 /	$\Phi 120$	Please see appendix A-2 and A-3			
<b>AF49</b>	193 M10	91 15	93 8	128.1 33	80 3.5	109 50	276 60	165 $\Phi 30k6$	145 M10	43 M8	25 14	180 /	$\Phi 120$				
<b>AF59</b>	220 M12	104.5 17	102 10	136 38	93 7	127 56	321 70	195 $\Phi 35k6$	170 M12	55 M12	25 20	200 /	$\Phi 160$				
<b>AF69</b>	242 M12	118.5 17	112 12	159.5 43	97 5	131 70	348 80	215 $\Phi 40k6$	190 M16	60 M12	25 22	212 /	$\Phi 160$				
<b>AF79</b>	294 M16	137.5 26	140 14	200 53.5	122 10	170 80	430 100	275 $\Phi 50k6$	240 M16	70 M12	35 17	270 /	$\Phi 200$				
<b>AF89</b>	344 M16	163 26	165 18	246.7 64	150 5	195 110	534 120	350 $\Phi 60m6$	310 M20	100 M16	40 29	330 /	$\Phi 250$				
<b>AF99</b>	415 M20	189.5 33	205 20	285 74.5	180 7.5	240 125	630 140	400 $\Phi 70m6$	350 M20	120 M16	50 28	400 /	$\Phi 300$				
<b>AF109</b>	484 M24	241.5 38	220 25	332.4 95	200 5	260 160	720 170	460 $\Phi 90m6$	400 M24	125 /	60 /	450 /	$\Phi 350$				
<b>AF129</b>	586 M30	292 45	270 28	382.6 116	236 15	316 180	861 210	520 $\Phi 110m6$	450 M24	142 /	70 /	530 10	$\Phi 450$				
<b>AF159</b>	662 M36	325 55	310 32	447 127	286 5	364 200	1021 210	620 $\Phi 120m6$	540 M24	170 /	80 /	660 15	$\Phi 550$				

Note:the dimensions don't include the height of the breathe valve.the height of the breathe valve is 17.

Note:When equipping the user's motor or the special one, the flange is required to connected. (Please see appendix D)