

Mounting Dimensional Description
AFHZ39-159

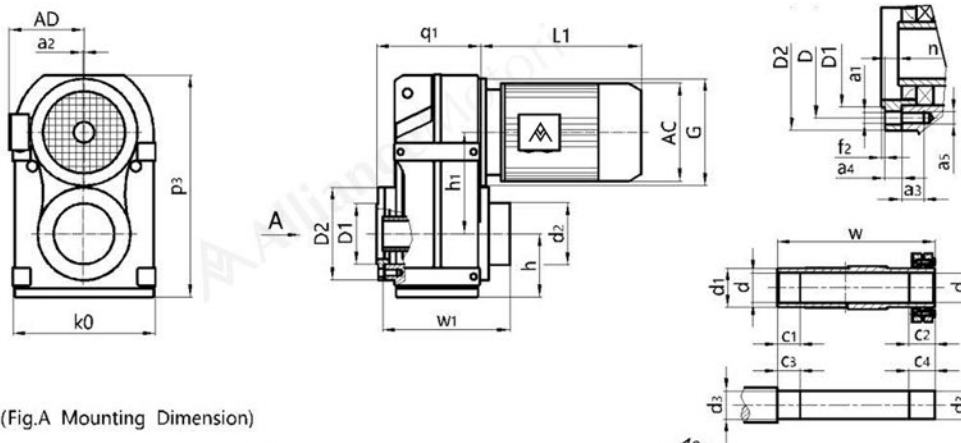

(Fig.A Mounting Dimension)

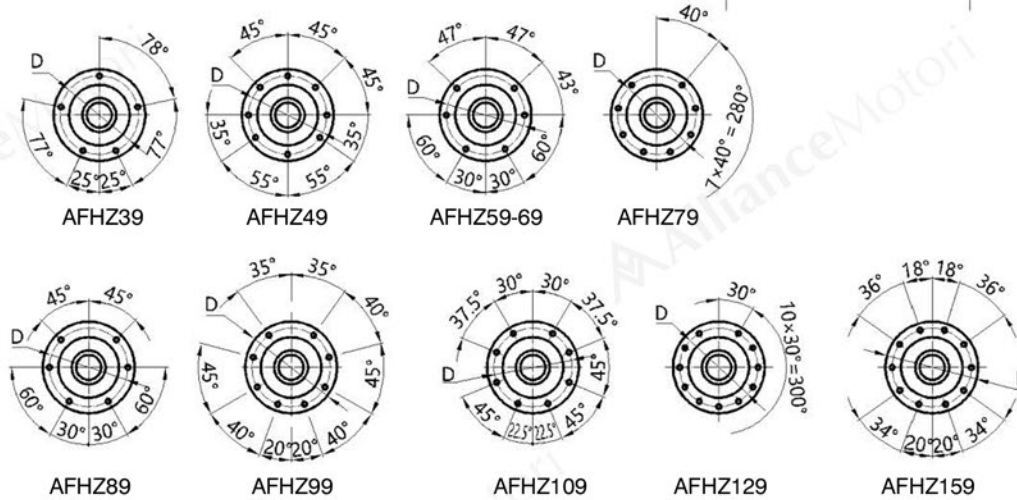

Type Size	q1 K0	h h1	D2 D1	p3 n	a4 a3	a5 G	w w1	c2 c1	c3 c4	d2 d1	d d3	a2 f2	a1 D	Motor Size							
														AC	AD	L1					
AFHZ39	122	77	Φ110	256	11.5	M8	146	31	25	Φ80	Φ30H7	/	Φ9	Please see appendix A-2 and A-3							
	165	112	Φ80j6	9	15	Φ120	152.5	20	36	Φ45	Φ30h6	3	Φ94								
AFHZ49	144	80	Φ120	276	11	M8	177	32	25	Φ88	Φ35H7	/	Φ9		Please see appendix A-2 and A-3						
	180	128.1	Φ80j6	8	14	Φ120	183	20	37	Φ50	Φ35h6	3	Φ102								
AFHZ59	162.5	93	Φ155	321	12	M12	195	26	25	Φ102	Φ40H7	/	Φ13.5			Please see appendix A-2 and A-3					
	200	136	Φ105j6	9	20	Φ160	202	20	31	Φ55	Φ40h6	3.5	Φ125								
AFHZ69	173	97	Φ155	348	12	M12	208	38	25	Φ102	Φ40H7	/	Φ13.5				Please see appendix A-2 and A-3				
	212	159.5	Φ105j6	8.5	22	Φ160	215.5	20	43	Φ55	Φ40h6	3.5	Φ125								
AFHZ79	206.5	122	Φ170	430	14	M12	241	36	35	Φ127	Φ50H7	/	Φ13.5					Please see appendix A-2 and A-3			
	270	200	Φ125j6	10	20	Φ200	249	30	41	Φ70	Φ50h6	3.5	Φ142								
AFHZ89	239	150	Φ215	534	15	M16	281	41	45	Φ157	Φ65H7	/	Φ17.5	Please see appendix A-2 and A-3							
	330	246.7	Φ155j6	11	29	Φ250	287	40	46	Φ85	Φ65h6	4	Φ178								
AFHZ99	292	180	Φ260	630	18	M16	345	55	55	Φ171	Φ75H7	/	Φ17.5		Please see appendix A-2 and A-3						
	400	285	Φ180j6	14	28	Φ300	352	50	60	Φ95	Φ75h6	4	Φ220								
AFHZ109	308	201	Φ304	723	22	M20	405	65	70	Φ234	Φ95H7	/	Φ22			Please see appendix A-2 and A-3					
	450	332.4	Φ210j6	-8	32	Φ350	417	60	75	Φ118	Φ95h6	4	Φ260								
AFHZ129	378	236	Φ350	861	30	M20	485	85	80	Φ233	Φ105H7	10	Φ22				Please see appendix A-2 and A-3				
	530	382.6	Φ250h6	0	36	Φ450	493	70	95	Φ135	Φ105h6	5	Φ300								
AFHZ159	455	286	Φ400	1021	28	M24	580	90	90	Φ287	Φ125H7	15	Φ26					Please see appendix A-2 and A-3			
	660	447	Φ290h6	-14	48	Φ550	592	80	100	Φ155	Φ125h6	5	Φ340								

Note:the dimensions don't include the height of the breathe valve.the height of the breathe valve is 17.

Note:When equipping the user's motor or the special one, the flange is required to connected. (Please see appendix D)